

AERODROME CHART - ICAO

ARP 403111.0N 0225815.3E

AD ELEV 6.83M / 22 FT

THESSALONIKI / MAKEDONIA Airport

- ELEVATIONS AND DIMENSIONS IN METERS
- BEARINGS ARE MAGNETIC
- COORDINATES IN WGS '84

RWY	DIRECTION MAG	THRESHOLD	THR Elevation (AMSL) GUND Elevation	TDZ ELEVATION (AMSL)	BEARING STRENGTH
10	99°	403126.92N 0225651.30	5.31 40.87	5.31	PCN
28	279°	403100.06N 0225913.15E	5.04 40.90	NIL	72/F/A/W/T
16	162°	403149.43N 0225803.17E	3.55 40.90	3.72	PCN
34	342°	403033.01N 0225827.46E	6.73 40.81	NIL	65/F/A/X/T

TWY type of surface: Asphalt. For restrictions for TWY "A3" see LGTS AD2.20.6.2  
Apron type of surface: Asphalt (FTO apron, Gen Av apron and stands 1 to 15) and concrete (stands 16 to 26)

INS COORDINATES FOR A/C STANDS

N°	LATITUDE	LONGITUDE
1	403131.29N	0225822.97E
2	403130.28N	0225824.29E
3	403128.71N	0225826.34E
4	403127.71N	0225827.84E
5	403126.71N	0225828.95E
6	403125.71N	0225830.26E
7	403124.71N	0225831.56E
8	403123.71N	0225832.87E
9	403122.28N	0225834.65E
10	403121.15N	0225837.25E
10a	403121.18N	0225835.80E
10b	403120.18N	0225837.11E
11	403119.19N	0225839.82E
11a	403119.17N	0225838.41E
11b	403118.17N	0225839.72E
12	403117.25N	0225842.41E
12a	403117.17N	0225841.03E
12b	403116.17N	0225842.33E
13	403116.60N	0225843.33E
13a	403117.19N	0225845.14E
14	403118.09N	0225847.31E
15	403118.61N	0225849.21E
16	403117.87N	0225852.14E
17	403117.51N	0225853.95E

INS COORDINATES FOR A/C STANDS

N°	LATITUDE	LONGITUDE
18	403117.19N	0225855.77E
19	403116.84N	0225857.59E
20	403116.50N	0225859.40E
21	403116.15N	0225861.22E
22	403115.81N	0225863.03E
23	403115.47N	0225864.85E
24	403115.11N	0225866.65E
25	403114.78N	0225868.47E
26	403114.43N	0225869.29E
27	403114.25N	0225897.35E
S1	403114.25N	0225907.35E
S2	403114.92N	0225907.57E
S3	403113.73N	0225910.01E
S4	403114.41N	0225910.23E
S5	403133.53N	0225916.13E

RUNWAY LIGHTING

- RWY 10-28**  
RWY EDGE Lights (White 2800 m / Yellow-White 600 m, LIH, 60m spacing)  
RWY END Lights (Red)  
RWY THR Lights (Green)  
RWY 10 TDZ Lights CAT II (White 900m/30m spacing)  
RWY C/L Lights (White 2500 m / Red-White 600 m / Red 300 m, LIH, 15m spacing)
- RWY 16-34**  
RWY EDGE Lights (White 1800 m / Yellow 600 m, LIH)  
RWY END Lights (Red)  
RWY THR Lights (Green)  
RWY C/L Lights (White 1500 m / Red-White 600 m / Red 300 m)  
RWY 16 TDZ Lights Cat II (White)

TAXIWAY LIGHTING

- TWYs "A", "A1", "A2", "A4", "A5", "A6"  
TWY C/L Lights (Green, LIH)  
EXIT TWY C/L Lights (Yellow-Green)  
STOP BAR Lights (Red. At RWY holding points of TWYs "A1", "A2" and "A6")  
RWY GUARD Lights (FLG Yellow. At RWY holding points of TWYs "A1", "A2" and "A6")  
TWYs "F1", "F2", "F3", "F4", "F5", "F", "F6", "F7", "F8", "F9", "F10"  
TWY EDGE Lights (Blue)  
TWY C/L Lights (Green)  
STOP BAR LIGHTS (Red)  
EXIT TWY C/L Lights (Yellow-Green)

APRON LIGHTING

- Floodlights

INS COORDINATES FOR A/C STANDS

N°	LATITUDE	LONGITUDE
S6	403134.88N	0225817.74E
S7	403135.87N	0225817.34E
S8	403132.32N	0225824.00E
S9	403131.90N	0225824.54E
S10	403131.44N	0225825.14E
S11	403131.55N	0225813.01E
S12	403112.27N	0225912.88E
H1	403113.73N	0225913.31E
H2	403112.72N	0225912.98E
H3	403133.74N	0225817.98E
H4	403134.95N	0225817.52E
H5	403136.17N	0225817.17E

LEGEND

SB ●●●●	STOP BARS
RGL	RUNWAY GUARD LIGHTS
⊙	APRON FLOODLIGHTS
○	OBSTACLE LIGHTS

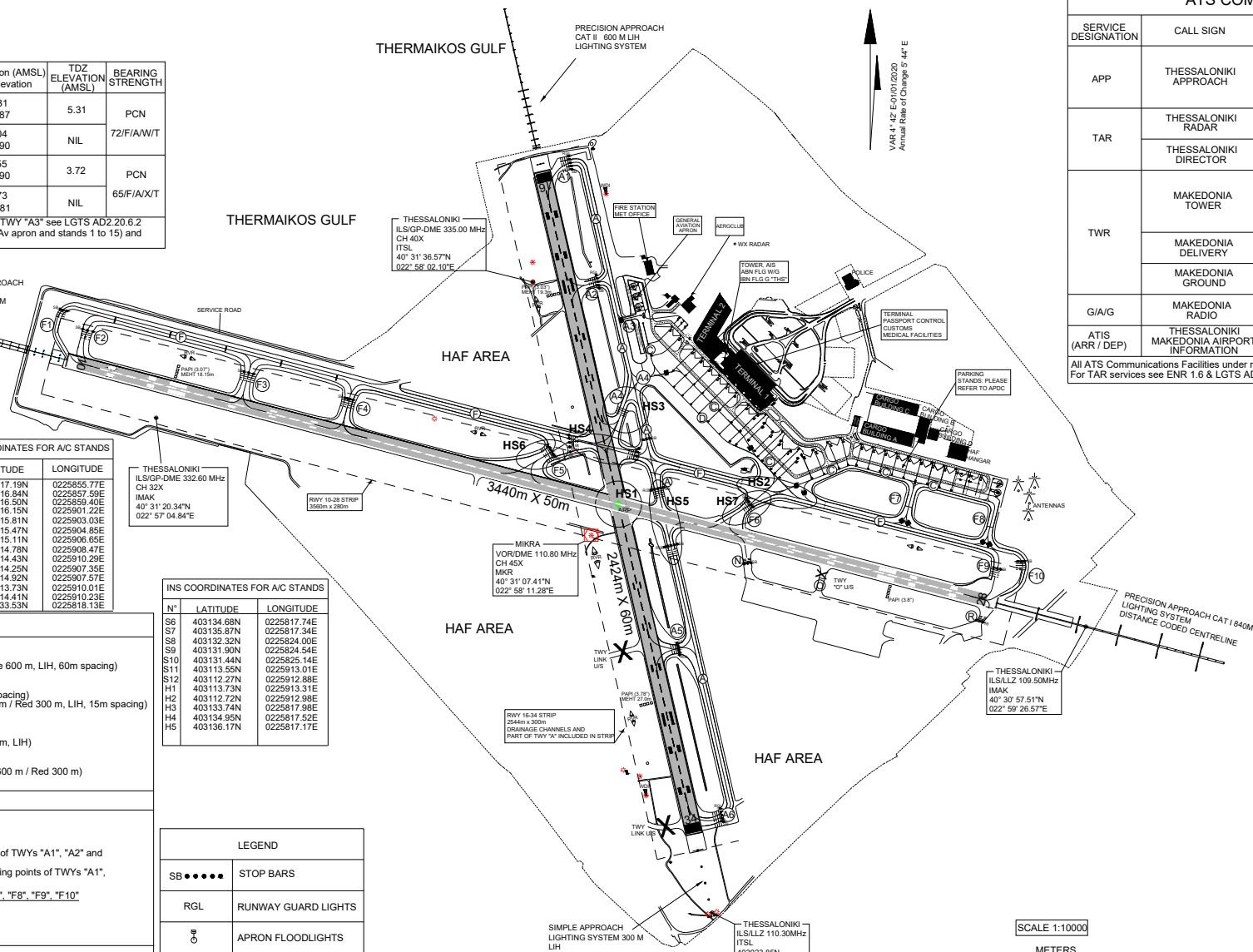

ATS COMMUNICATIONS FACILITIES				
SERVICE DESIGNATION	CALL SIGN	FREQUENCY/VHF CH	OPERATIONAL HOURS	REMARKS
APP	THESSALONIKI APPROACH	120.800	H24	Primary freq cover. FL 150/ 40NM Coverage FL 250/ 50NM MIL RGA Emergency MIL Emergency
		118.280	H24	
		362.300 MHz	H24	
		122.100 121.500 243.000 MHz	H24	
TAR	THESSALONIKI RADAR	120.800	H24	Coverage FL 150/ 40NM MIL
		THESSALONIKI DIRECTOR	118.280	
TWR	MAKEDONIA TOWER	118.105	H24	Primary freq cover. FL 40/ 25NM Coverage FL 40/ 25NM RGA MIL RGA Emergency MIL Emergency
		118.055	H24	
		257.800 MHz 121.500 243.000 MHz	H24	
		118.055	Operating on ATC instructions	
G/A/G	MAKEDONIA RADIO	5637 kHz	H24: 0400-1700 H24: 1700-0400	Primary Primary
		127.555	H24	
ATIS (ARR / DEP)	THESSALONIKI MAKEDONIA AIRPORT INFORMATION	127.555	H24	Coverage FL 200/ 60NM

All ATS Communications Facilities under responsibility of CAA.  
For TAR services see ENR 1.6 & LGTS AD 2.22.4, for ATIS see also ENR 1.1.1.8.3.3

- Hot Spot HS1**  
INTERSECTION OF RWYS
- Hot Spot HS5**  
INTERSECTION OF RWY 10/28 WITH TWY A: INTERSECTION WITH PAVEMENT MARKINGS AND SIGNAGE TO WARN AGAINST ENTRY TO RWY 10/28 FROM TWY A.
- Hot Spot HS2**  
WIDE OPENING. WHERE APPLICABLE MAKE SURE OF CORRECT TURN FROM APRON TO TWY "F" BEFORE RWY 10-28.
- Hot Spot HS6**  
RWY F5: NOT TO BE USED AS RAPID EXIT TWY. AIRCRAFT VACATING RWY 10/28 VIA TWY F5 SHALL HOLD SHORT ON RWY HOLDING POSITION OF RWY 16/34.
- Hot Spot HS3**  
TAXILINK "AA" NOT TO BE USED AS RAPID EXIT TAXIWAY.
- Hot Spot HS4**  
INTERSECTION OF RWY 16/34 WITH TWY F: INTERSECTION WITH PAVEMENT MARKINGS AND SIGNAGE TO WARN AGAINST ENTRY TO RWY 16/34 FROM TWY F.
- Hot Spot HS7**  
RWY F6: NOT TO BE USED AS RAPID EXIT TWY.

**CHANGES:**  
- TWY N & TWY R : STOP BAR LIGHTS ADDED

