

AERODROME CHART-ICAO

36°34'48"N  
26°22'31"E

ELEV 50.38m  
165.29ft

ASTYPALAIA / ASTYPALAIA Airport

-ELEVATIONS AND DIMENSIONS IN METERS  
-BEARINGS ARE MAGNETIC  
-COORDINATES IN WGS' 84

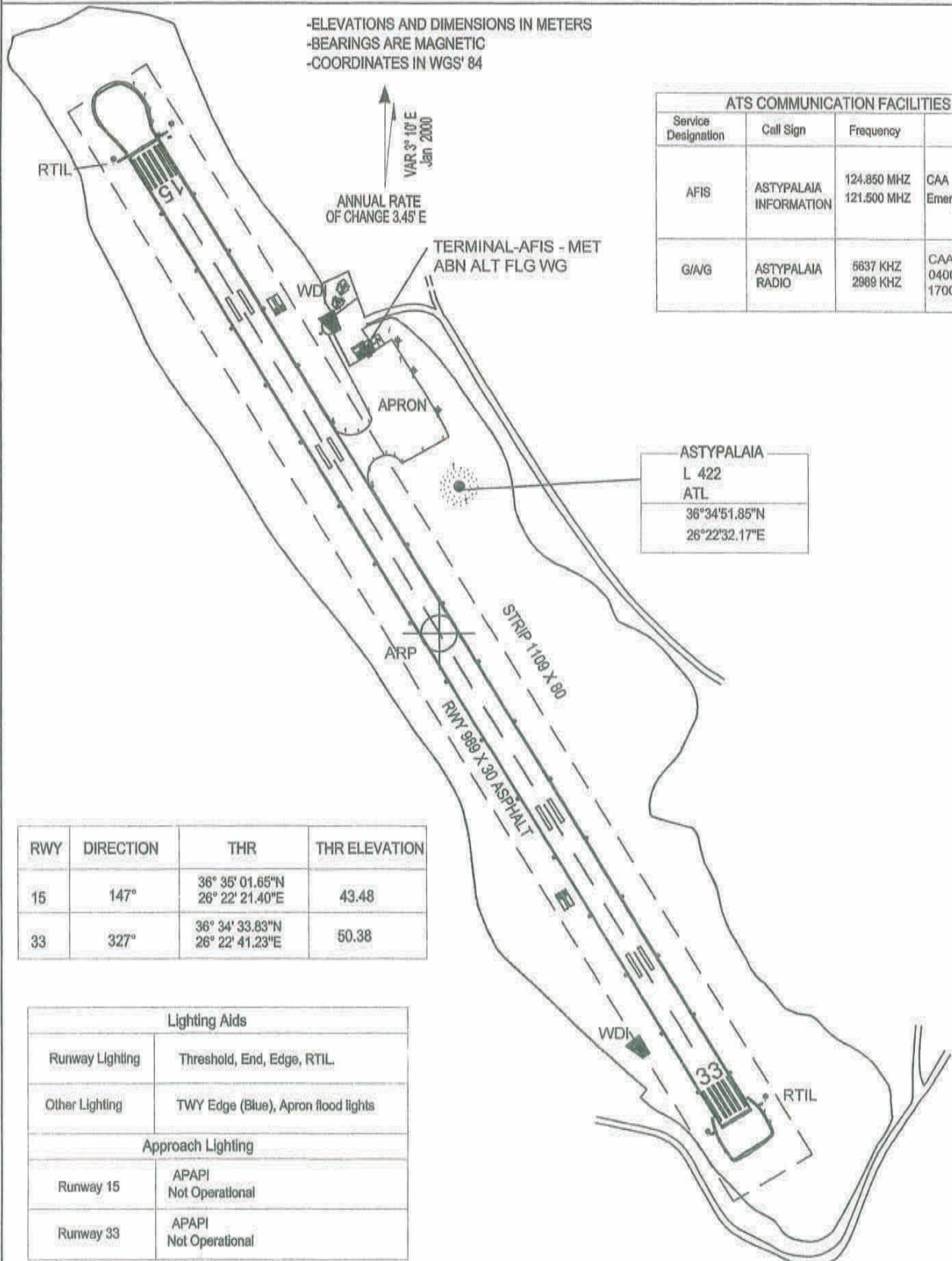

ATS COMMUNICATION FACILITIES			
Service Designation	Call Sign	Frequency	Remarks
AFIS	ASTYPALAIA INFORMATION	124.850 MHZ 121.500 MHZ	CAA Emergency Frequency
G/A/G	ASTYPALAIA RADIO	5637 KHZ 2989 KHZ	CAA 0400 - 1700 1700 - 0400

RWY	DIRECTION	THR	THR ELEVATION
15	147°	36° 35' 01.65"N 26° 22' 21.40"E	43.48
33	327°	36° 34' 33.83"N 26° 22' 41.23"E	50.38

Lighting Aids	
Runway Lighting	Threshold, End, Edge, RTIL
Other Lighting	TWY Edge (Blue), Apron flood lights
Approach Lighting	
Runway 15	APAPI Not Operational
Runway 33	APAPI Not Operational

AMENDMENT RECORD		
No	DATE	ENTERED BY

