

AIRCRAFT PARKING / DOCKING CHART - ICAO

APRON ELEV : 61.25m
200.95 ft

KAVALA - AMYGDALION / LYDIA AERODROME

- ELEVATIONS AND DIMENSIONS IN METERS
- BEARINGS ARE MAGNETIC
- COORDINATES IN WGS' 84

Aircraft Parking Stands			
NORTH APRON			
STAND	LATITUDE	LONGITUDE	MAX WINGSPAN
N1	N40° 58' 18.44"	E24° 20' 51.82"	15m
N2	N40° 58' 18.06"	E24° 20' 52.49"	15m
N3	N40° 58' 17.68"	E24° 20' 52.23"	15m
N4	N40° 58' 17.31"	E24° 20' 50.64"	15m
N5	N40° 58' 16.55"	E24° 20' 49.47"	15m
N6	N40° 58' 16.17"	E24° 20' 48.88"	15m
N7	N40° 58' 15.79"	E24° 20' 48.30"	15m
N8	N40° 58' 15.42"	E24° 20' 47.71"	15m
N9	N40° 58' 15.04"	E24° 20' 47.12"	15m
N10	N40° 58' 14.66"	E24° 20' 46.54"	15m
N11	N40° 58' 17.70"	E24° 20' 52.24"	15m
N12	N40° 58' 17.32"	E24° 20' 52.65"	15m
N13	N40° 58' 16.94"	E24° 20' 52.06"	15m
N14	N40° 58' 16.56"	E24° 20' 51.48"	15m
N15	N40° 58' 15.81"	E24° 20' 50.30"	15m
N16	N40° 58' 15.43"	E24° 20' 49.71"	15m
N17	N40° 58' 15.05"	E24° 20' 49.13"	15m
N18	N40° 58' 14.67"	E24° 20' 48.54"	15m
N19	N40° 58' 14.30"	E24° 20' 47.95"	15m
N20	N40° 58' 13.92"	E24° 20' 47.37"	15m
N21	N40° 58' 14.69"	E24° 20' 50.55"	15m
N22	N40° 58' 14.31"	E24° 20' 49.96"	15m
N23	N40° 58' 13.93"	E24° 20' 49.37"	15m
N24	N40° 58' 13.56"	E24° 20' 48.78"	15m
N25	N40° 58' 13.18"	E24° 20' 48.20"	15m

SOUTH APRON			
STAND	LATITUDE	LONGITUDE	MAX WINGSPAN
S1	N40° 58' 12.41"	E24° 20' 51.97"	15m
S2	N40° 58' 11.86"	E24° 20' 51.72"	15m
S3	N40° 58' 11.30"	E24° 20' 51.46"	15m

ATS COMMUNICATION FACILITIES			
Service Designation	Callsign	Frequency	Remarks
G/A/G	LYDIA RADIO	135.505 MHz	Cov. FL030/30NM

LEGEND	
TAXIWAY EDGE LIGHT	●
TAXIWAY CENTRE LINE	—
TAXIWAY DESIGNATOR	(A)
AIRCRAFT STAND	S1
SIGN	○

- APRONS NORTH (N) AND SOUTH (S): ASPHALT
- THE COORDINATES PROVIDED REPRESENT ILLUSTRATED STOP BARS IN ASPHALT APRONS

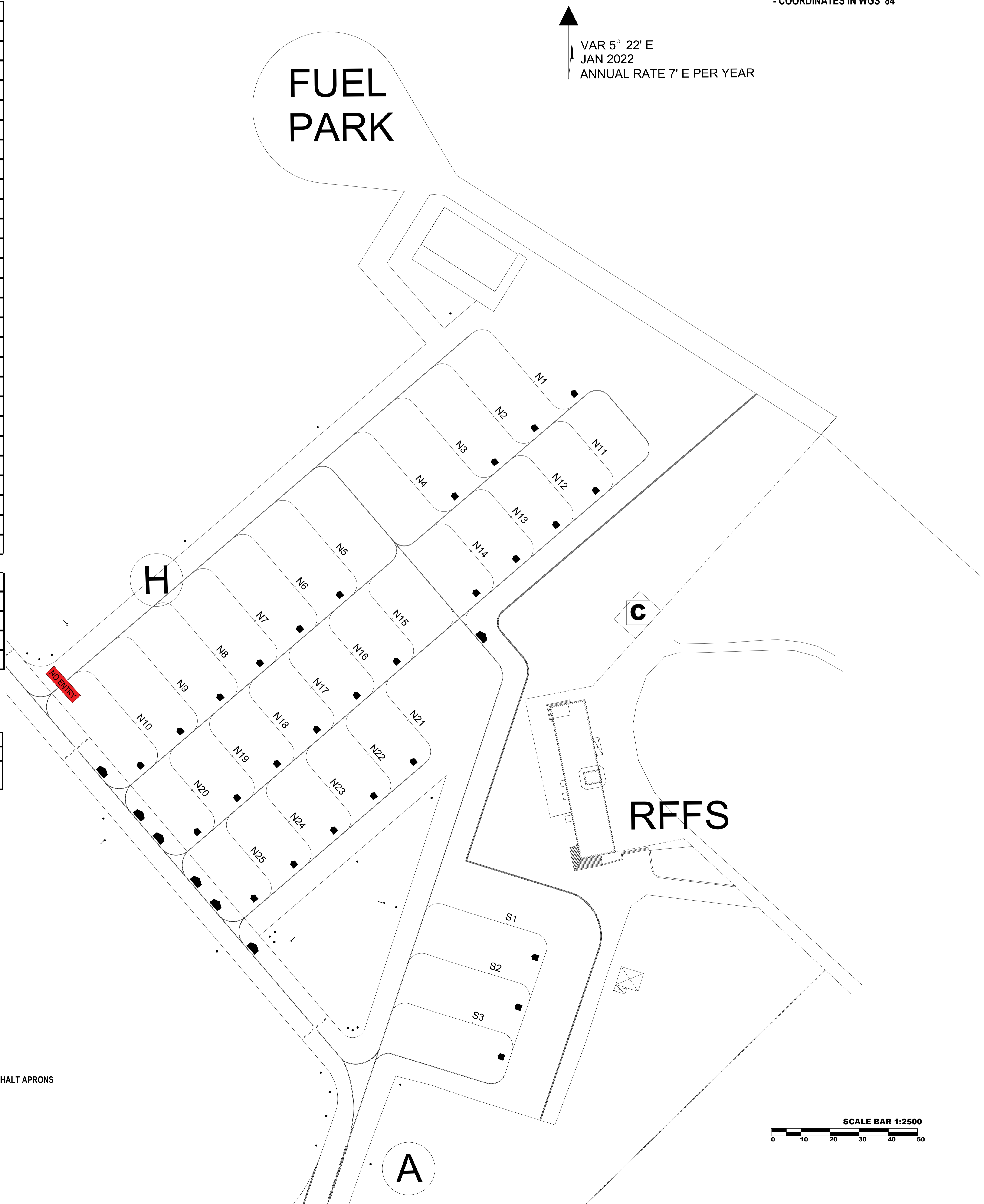

SCALE BAR 1:2500
0 10 20 30 40 50